

Relative Humidity and Temperature HygroWiz



- Local or remote display
- Analogue output(s) 4-20 mA
- Relay output(s)
- Interface RS485 with MODBUS RTU

APPLICATIONS

- For automation of HVAC network
- Storage areas, cool stores, greenhouses, animal husbandry
- Museums, Data centers, weather stations

DESCRIPTION

Hygrowiz measures the temperature and relative humidity of the air. The temperature and humidity probe is integrated or cable connected to the housing. Standard version: the probe has a PTFE tap filter to limit the impact of water splashes (non-absorbent and anti-corrosion surface).

Choose the right version for your application, with remote signals, relay outputs, 4-20 mA signals, interface RS485 MODBUS protocole. Please, request more information when necessary.

HygroWiz is available as a blind version, without display. For an easy start-up, HydroWiz is set up by ourselves before shipment, according to your needs (to list them on P.O.).



Front view

Front view

1	1 or 2 outputs
2	Interface RS485 / MODBUS
3	Visual alarm indicator + acoustic alarm
4	Customizable graphic displays
5	To save settings or access to software
6	AISI 316 L probe (according model)
7	Temperature & humidity sensors; Max. 120 °C & 100 % RH
8	Not used
9	Not used
10	Housing, IP 65
11	Not used
12	LCD; 2.9" display
13	2 LED for status of outputs



QM 612

BAMO INTERNATIONAL

22, Rue de la Voie des Bans · Z.I. de la gare · 95100 ARGENTEUIL

Tel +33 (0)1 30 25 83 20 Web www.bamo.eu

Fax +33 (0)1 34 10 16 05 E-mail export@bamo.fr

Relative Humidity and
Temperature
HygroWiz

29-06-2020

D-671.01-EN-AB

TE

671-01 /1

TECHNICAL FEATURES

Power supply	24 V DC (11 ... 36 V DC) – Consumption maxi 2.5 W
Display	Backlit, graphic LCD – 128 x 64 pixels
Ambient temperature	-20 ... +70 °C (Version without display: -30 ... +80 °C)
Protection	IP 65 (Version without display: IP 67)
Housing	Wall mounting Dimensions: 120 x 90 x 50 mm Materials: ASA (Luran®) and polycarbonate

Probe for QM-212 model:

Type	Integrated to the display unit
Dimensions	Height: 90 mm; O.D.: 18 mm
Materials:	AISI 316 L; PTFE tap filter
Temperature	-30 ... +105 °C ($\pm 0,2$ °C from 10 to 60 °C) ± 0.4 °C at 30 °C ; ± 0.7 °C at 105 °C
Humidity	0to 100 % RH (± 1.8 % RH from 20 to 80 % RH at 25 °C)

Probes for QM-612 model:

Type	Output cable, to connect to the housing
Dimensions	Length: 90 mm; O.D. 18 mm
Materials	AISI 316 L; PTFE tap filter Cable with PUR coating: Max. 80 °C; Or TPE: Max. 120 °C
Temperature	-40 ... +120 °C (± 0.2 °C from 10 to 60 °C) (± 0.4 °C at -30 °C ; ± 0.7 °C at 120 °C)
Humidity	0... 100 % RH (± 1.8 % RH from 20 to 80 % RH at 25 °C)
Connections	Cable gland or connector type M12 - 4 pins

Outputs (options):

Relay outputs	0, 1 or 2 relay outputs, N.O. Rated: 24 V AC / 35 V DC, 200 mA
Analogue outputs	0, 1 or 2 outputs: 0/4-20 mA (0/24 mA max.) Active signal, no galvanic insulation
Interface	RS485; 8N1 & 8N2; 1,200 ... 115,200 bit/s; MODBUS RTU; no galvanic insulation

EC Conformity: The instrument meets the legal requirements of the current European Directives.

Examples of complete systems:

2 x Relays
1 x RS485



2 x 0/4-20 mA
1 x RS485



1 x 0/4-20 mA
1 x Relay
1 x RS485



BAMO INTERNATIONAL

22, Rue de la Voie des Bans · Z.I. de la gare · 95100 ARGENTEUIL
Tel +33 (0)1 30 25 83 20 Web www.bamo.eu
Fax +33 (0)1 34 10 16 05 E-mail export@bamo.fr

Relative Humidity and
Temperature
HygroWiz

29-06-2020

D-671.01-EN-AB

TE

671-01 /2

TABLE TO BUILT A TRANSMITTER

Series

QM QM Series

Model

212 Transmitter with integrated probe O.D. 18 mm, 90 mm high

612 Transmitter with cable output probe or with a M12 connector

Cable length for 612 model

- 00** Without cable
- 05** Cable length 0.5 m
- 10** Cable length 1 m
- 15** Cable length 1.5 m
- 20** Cable length 2 m
- 25** Cable length 2.5 m
- 30** Cable length 3 m

Connections and cable types for 612 model

- 0** None – Only for integrated probe (QM-212-00-0)
- 1** Cable gland with PUR coating; -30 ... +80 °C
- 2** M12 connector, with PUR coating for probe O.D. 18 mm; -30 ... +80 °C
- 3** Cable gland with TPE coating; -30 ... +120 °C
- 4** M12 connector with TPE coating for probe O.D. 18 mm; -30 ... +120 °C

Input channel 1

- 3** Probe with temperature and humidity sensors

Input channel 2

- 0** None

Outputs

- 00** None
- 11** 2 Relays
- 21** 1 Relay + 1 Analogue output 0/4-20 mA, active, no galvanic insulation;
- 22** 2 Analogue outputs 0/4-20 mA, active signal, no galvanic insulation

Display

- None**, blind version
- 1** LCD, resolution 128 x 64 pixels

Cable glands, quantity

- 3** 3 pieces

QM 212 00 0 3 0 00 1 10 3 3

671

671



22, Rue de la Voie des Bans · Z.I. de la gare · 95100 ARGENTEUIL
 Tel +33 (0)1 30 25 83 20 Web www.bamo.eu
 Fax +33 (0)1 34 10 16 05 E-mail export@bamo.fr

**Relative Humidity and
 Temperature
 HygroWiz**

29-06-2020

D-671.01-EN-AB

TE

671-01 /3

SPARE PARTS

Output cable probe

Connector type

2 Connector for operating temperature -30 ... +80 °C

Measurement types

3 Temperature and humidity

PPQ-612-00 2 3

Probe without cable

Cable length

05 0.5 m

10 1 m

15 1.5 m

20 2 m

25 2.5 m

30 3 m

Cable glands

1 Cable gland with PUR coating (-30 ... +80 °C)

3 Cable gland with TPE coating (-30 ... +120 °C)

Measurement types

3 Temperature and humidity

PPQ-612 XX X 3



PPQ-622-XX-X-X

Cable output probe, O.D. 12 mm; Length: 300 mm; AISI 316 L; Filter 25 µm, in stainless steel

PPQ-612-XX-X-X

Cable output probe, O.D. 18 mm; Length: 900 mm; AISI 316 L; Filter: FPQ-P350

PPQ-612-00-X-X

Probe without cable, O.D. 18 mm; Length 90 mm; AISI 316 L; Filter FPQ-P350



FPQ-P350

PTFE filter (limits the impact of water splashes), non-absorbent surface, anti-corrosion, -30 ... 120 °C



MOUNTING ACCESSORIES – CONNECTORS

HPQ-FS12

Flat round flange AISI 316L, for probes O.D. 12 mm



HPQ-TS12

Adjustable fitting M20 x 1.5 AISI 316 L, for probes O.D. 12 mm



HPQ-W1218

Wall mount bracket AISI 316L, for probes O.D. 12 & 18 mm

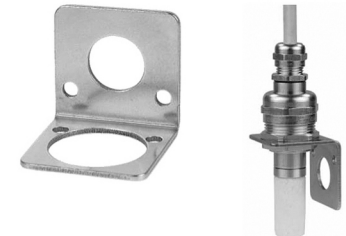

HPQ-CGS18

Adjustable fitting M25x1.5, for probes O.D. 18 mm



CPQ-00

Connector M12 - 4 pins, for probes PPQ-612, -30 ... +80 °C



CPX-30

Cable 3 m long with connector M12 - 4 pins, for probes PPQ-612



CPQ-30 : Cable: PUR coating, -30 ... +80 °C

CPT-30 : Cable: TPE coating, -30 ... +120 °C

BAMO INTERNATIONAL

22, Rue de la Voie des Bans · Z.I. de la gare · 95100 ARGENTEUIL

Tel +33 (0)1 30 25 83 20 Web www.bamo.eu

Fax +33 (0)1 34 10 16 05 E-mail export@bamo.fr

Relative Humidity and
Temperature
HygroWiz

29-06-2020

D-671.01-EN-AB

TE

671-01 /4