

Needle valve A 32



- Made from metal bar stock
- Operating pressure: 413 bar Max.
- Temperature: 240 °C Max.

APPLICATIONS

Designed for direct mounting on pipe for liquid, gas or steam, this shut-off valve can be used to isolate a pressure gauge.

TECHNICAL FEATURES

WET PARTS

Body	AISI 316
Stem thread	AISI 316
Needle	AISI 316
Sealing	PTFE (200 °C Max.)

FITTINGS

Gauge side	1/2" BSP-F
Process side	1/2" BSP-M
Drain plug	1/4" NPT - F

OPTIONS Degreasing for application with oxygen

EC Conformity: The instrument meets the legal requirements of the current European Directives

DIMENSIONS

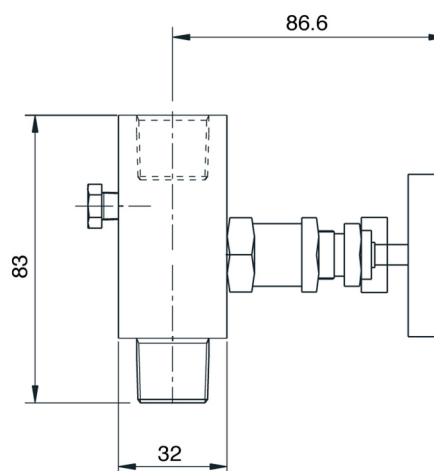

CODE NUMBERS AND REFERENCES

Needle valve, AISI 316, made from metal bar stock ,
With drain plug 1/4" NPT - F

Code	Reference	Description
816 476	V 102	Fittings, 1/2" BSP-F to gauge and 1/2" BSP-M to process

Options, certificates, other versions: on request

BAMO INTERNATIONAL

22, Rue de la Voie des Bans · Z.I. de la gare · 95100 ARGENTEUIL

Tel +33 (0)1 30 25 83 20 Web www.bamo.eu

Fax +33 (0)1 34 10 16 05 E-mail export@bamo.fr

Needle valve
A 32

12-07-2018

D-816.01-EN-AA

PR

816-01 /1