

# Pneumatically actuated 2-way ball valves VP2V M1

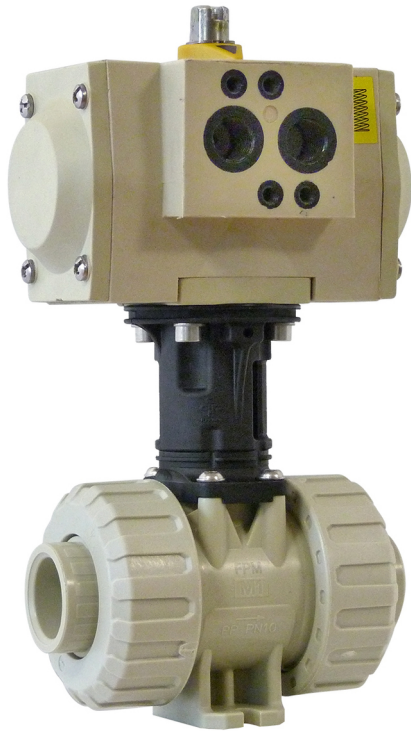

- PVC-U or PPH or PVDF valves  
From ND 10 up to ND 100
- Pneumatic actuator  
Single or double acting
- **OPTIONS:**  
Limit switches box  
Pilot valves

## APPLICATIONS

These valves are suitable for applications even with aggressive liquids.

## DESCRIPTION

Pneumatically actuated 2-way ball valves controlled by pneumatic actuator single acting (N.C. or N.O) or double acting, are useful to allow or to stop the flow of liquids in piping systems. The PTFE seat of the ball provides this valve with a long service life.

These modular valves receive various accessories for pneumatic actuators, such as limit switches, pilot valves, exhaust silencer and exhaust damper. For complete information on accessories, refer to data sheet da913-10.

## TECHNICAL FEATURES

### 2-way ball valves:

Body	PVC-U, PPH, or PVDF
Seals	EPDM or FPM (With PVDF body: FPM seals only)
Ball	Material identical to the valve body
Ball seat	PTFE
Fittings	Female unions (socket-ends), PVC, PPH or PVDF

**Accessories:** Mounting bracket for fixing and raising  
(Availability: For valves DN 10 to DN 50)

### Pneumatic actuators

Models	Single acting (N.O. or N.C.) versions, or double acting version
Operating pressure	Min. 6 bar; Max. 8 bar
Fittings	BSP 1/4" G female
<b>Conformity</b>	<b>NAMUR VDI/VDE 3845 and ISO 5211</b>

### Accessories:

(See data sheet da 913-10)

- Limit switches box
- 3/2-way pilot valves for single acting version
- 5/2-way pilot valves for double acting version
- Exhaust silencer
- Exhaust damper

**EC Conformity:** The instrument meets the legal requirements of the current European Directives.

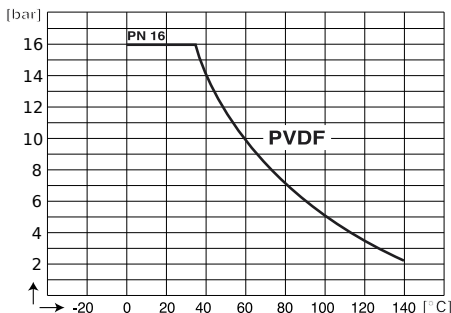
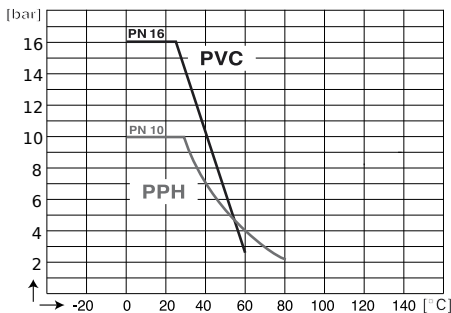

Pressure vs. Temperature

**BAMO** INTERNATIONAL

22, Rue de la Voie des Bans · Z.I. de la gare · 95100 ARGENTEUIL

Tel +33 (0)1 30 25 83 20 Web [www.bamo.eu](http://www.bamo.eu)

Fax +33 (0)1 34 10 16 05 E-mail [export@bamo.fr](mailto:export@bamo.fr)

Pneumatically actuated 2-way  
ball valves  
**VP2V M1**

19-11-2019

D-913.21-EN-AA

PLAS

913-21 /1

## CODE NUMBERS AND REFERENCES

### PVC-U valves — PN 16

ND	d	Single acting N.C.		Single acting N.O.		Double acting	
		EPDM seals	FPM seals	EPDM seals	FPM seals	EPDM seals	FPM seals
10	16	913 001 M	913 011 M	913 021 M	913 031 M	913 041 M	913 051 M
15	20	913 002 M	913 012 M	913 022 M	913 032 M	913 042 M	913 052 M
20	25	913 003 M	913 013 M	913 023 M	913 033 M	913 043 M	913 053 M
25	32	913 004 M	913 014 M	913 024 M	913 034 M	913 044 M	913 054 M
32	40	913 005 M	913 015 M	913 025 M	913 035 M	913 045 M	913 055 M
40	50	913 006 M	913 016 M	913 026 M	913 036 M	913 046 M	913 056 M
50	63	913 007 M	913 017 M	913 027 M	913 037 M	913 047 M	913 057 M
65	75	913 008 M	913 018 M	913 028 M	913 038 M	913 048 M	913 058 M
80	90	913 009 M	913 019 M	913 029 M	913 039 M	913 049 M	913 059 M
100	110	913 010 M	913 020 M	913 030 M	913 040 M	913 050 M	913 060 M

### PPH valves — PN 10

ND	d	Single acting N.C.		Single acting N.O.		Double acting	
		EPDM seals	FPM Seals	EPDM seals	FPM seals	EPDM seals	FPM seals
10	16	913 301 M	913 311 M	913 321 M	913 331 M	913 341 M	913 351 M
15	20	913 302 M	913 312 M	913 322 M	913 332 M	913 342 M	913 352 M
20	25	913 303 M	913 313 M	913 323 M	913 333 M	913 343 M	913 353 M
25	32	913 304 M	913 314 M	913 324 M	913 334 M	913 344 M	913 354 M
32	40	913 305 M	913 315 M	913 325 M	913 335 M	913 345 M	913 355 M
40	50	913 306 M	913 316 M	913 326 M	913 336 M	913 346 M	913 356 M
50	63	913 307 M	913 317 M	913 327 M	913 337 M	913 347 M	913 357 M
65	75	913 308 M	913 318 M	913 328 M	913 338 M	913 348 M	913 358 M
80	90	913 309 M	913 319 M	913 329 M	913 339 M	913 349 M	913 359 M
100	100	913 310 M	913 320 M	913 330 M	913 340 M	913 350 M	913 360 M

### PVDF valves — PN 16

ND	d	Single acting N.C.	Single acting N.O.	Double acting
		FPM seals	FPM seals	FPM seals
10	16	913 601 M	913 611 M	913 621 M
15	20	913 602 M	913 612 M	913 622 M
20	25	913 603 M	913 613 M	913 623 M
25	32	913 604 M	913 614 M	913 624 M
32	40	913 605 M	913 615 M	913 625 M
40	50	913 606 M	913 616 M	913 626 M
50	63	913 607 M	913 617 M	913 627 M
65	75	913 608 M	913 618 M	913 628 M
80	90	913 609 M	913 619 M	913 629 M
100	110	913 610 M	913 620 M	913 630 M

### Mounting accessory (up to ND 50)

Code	Description
141776	Mounting accessory, dual function, for valves M1: ND 10, 15 and 20
141777	Mounting accessory, double function, for valves M1: ND 25, 32, 40 and 50

Detailed information about mounting accessories is on the data sheet da934-04.

**BAMO** INTERNATIONAL

22, Rue de la Voie des Bans · Z.I. de la gare · 95100 ARGENTEUIL  
 Tel +33 (0)1 30 25 83 20 Web [www.bamo.eu](http://www.bamo.eu)  
 Fax +33 (0)1 34 10 16 05 E-mail [export@bamo.fr](mailto:export@bamo.fr)

Pneumatically actuated 2-way  
ball valves  
**VP2V M1**

19-11-2019

D-913.21-EN-AA

**PLAS**

**913-21 /2**

## DIMENSIONS [mm]

SE\* : Single acting -- DE\*\* : Double acting

PVC-U valves — PN 16						SE*		DE**	
ND	d	H	L	E	H1	L1	H2	L1	H2
10	16	33	83	5.5	113	119	91	119	91
15	20				125.5				
20	25	40	98.5						
25	32	43	106	6.5	131	160	112	160	112
32	40	51	121.5		148				
40	50	56	149		159				
50	63	64	175	8.3	173.5	175	132.5	160	112
65	75	85	211		221.5				
80	90	100	265.5	10.3	259.5	239	112	175	132
100	110		284						

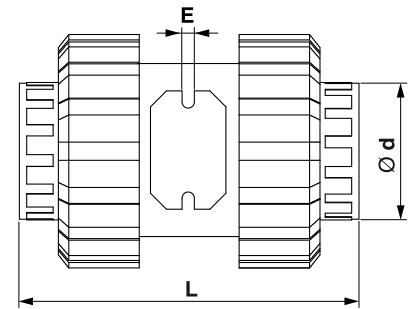

Corps de vanne PP-H — PN 10						SE*		DE**	
ND	d	H	L	E	H1	L1	H2	L1	H2
10	16	33	98.5	5.5	114	119	91	119	91
15	20				126.5				
20	25	40	113						
25	32	43.5	123	6.5	133	160	112	160	112
32	40	51	141		148				
40	50	56.5	164		161				
50	63	64.5	194.5	8.3	176	175	132.5	160	112
65	75	85	231		223.5				
80	90	100	283.5	10.3	268	239	112	175	132
100	110		291.5						

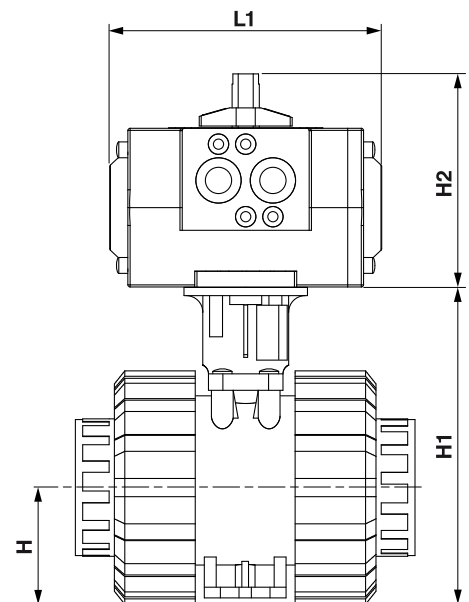

PVDF valves — PN 16						SE*		DE**	
ND	d	H	L	E	H1	L1	H2	L1	H2
10	16	33	98.5	5.5	114	119	91	119	91
15	20				126.5				
20	25	40	113						
25	32	43.5	123	6.5	133	160	112	160	112
32	40	51	141		148				
40	50	56.5	164		161				
50	63	64.5	194.5	8.3	176	175	132.5	160	112
65	75	85	228,8		223.5				
80	90	100	282	10.3	268	239	112	175	132
100	110		251						

# BAMO

INTERNATIONAL  
 22, Rue de la Voie des Bans · Z.I. de la gare · 95100 ARGENTEUIL  
 Tel +33 (0)1 30 25 83 20 Web [www.bamo.eu](http://www.bamo.eu)  
 Fax +33 (0)1 34 10 16 05 E-mail [export@bamo.fr](mailto:export@bamo.fr)

**Pneumatically actuated 2-way  
 ball valves  
 VP2V M1**

19-11-2019

D-913.21-EN-AA

**PLAS**

**913-21 /3**

## PHYSICAL FEATURES PVC-U Valves

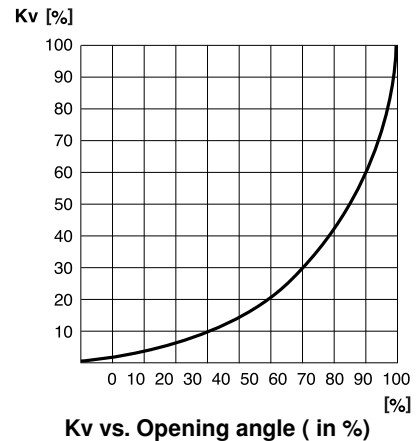
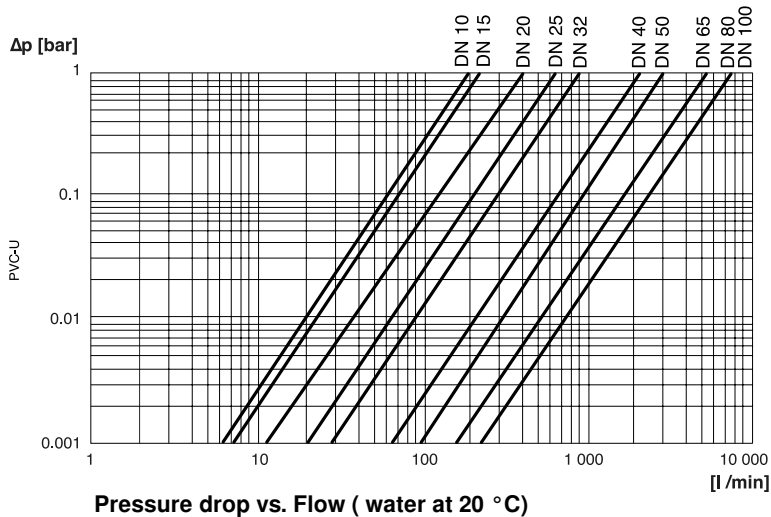

Flow factor: Kv (water at 20 °C)

PVC-U : PN 16	ND 10	ND 15	ND 20	ND 25	ND 32	ND 40	ND 50	ND 65	ND 80	ND 100
	d 16	d 20	d 25	d 32	d 40	d 50	d 63	d 75	d 90	d 110
Pressure drop 1 bar, Q [l/min]	198	225	400	630	900	2120	3000	5150	7600	
Pressure drop 1 mbar, Q [l/min]	6.2	7.1	12.6	19.9	28.4	67	94.8	162.8	240.3	

## PHYSICAL FEATURES — PP-H & PVDF valves

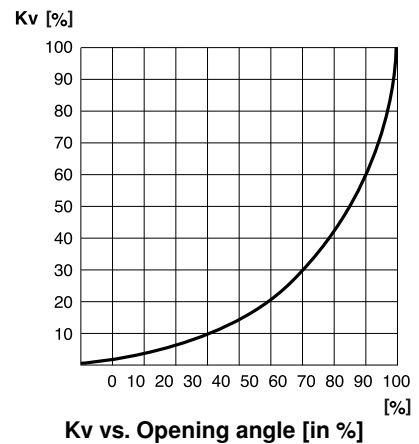
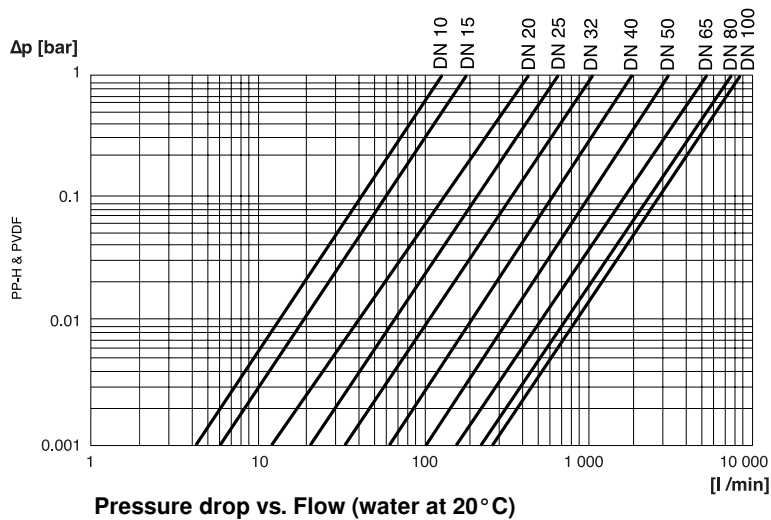

Flow factor Kv (water at 20 °C)

PP-H: PN 10	ND 10	ND 15	ND 20	ND 25	ND 32	ND 40	ND 50	ND 65	ND 80	ND 100
PVDF: PN 16	d 16	d 20	d 25	d 32	d 40	d 50	d 63	d 75	d 90	d 110
Pressure drop 1 bar, Q [l/min]	130	190	440	650	1080	1980	3240	5200	7500	8850
Pressure drop 1 mbar, Q [l/min]	4.1	6.0	13.9	20.6	34.2	62.6	102.5	164.4	237.1	279.8

**BAMO** INTERNATIONAL

22, Rue de la Voie des Bans · Z.I. de la gare · 95100 ARGENTEUIL  
 Tel +33 (0)1 30 25 83 20 Web [www.bamo.eu](http://www.bamo.eu)  
 Fax +33 (0)1 34 10 16 05 E-mail [export@bamo.fr](mailto:export@bamo.fr)

Pneumatically actuated 2-way  
 ball valves  
**VP2V M1**

19-11-2019

D-913.21-EN-AA

**PLAS**

**913-21 /4**