

Leakage monitor WM25



SAFETY PRECAUTIONS

- Installation, initial start-up and maintenance may only be performed by trained personnel!
- The device may only be connected to power which complies with the specifications included in the technical data and on the serial plate!
- The device must be disconnected from all sources of power during installation and maintenance work!
- The device may only be operated under the conditions specified in these operating instructions!

FUNCTIONS DESCRIPTION

The WM25 leakage sensor is used to monitor leakage in rooms and open catch basins. It detects conductive media such as tap water, industrial water and wastewater. Mounted to the floor, it triggers an alarm as soon as escaping medium is detected. The desired trigger height can be adjusted using the plastic screws on the bottom of the unit.

TECHNICAL DATA

Supply power	UNom= 24V DC (18 - 30V DC)
Current consumption	max. 20mA
Sensitivity	approx. 0.8 - 1M Ω (ca. 1 - 1.25 μ S)
Measuring current	approx. 1mA
Relay contact	changeover contact, max. 60V / 0.5A
Reset-function	throughout magnet fixed on cable
Connector cable	PVC, approx. 5m long, 5 x 0.14 sq.mm, longer cables upon request (max. 50m)
Temperature range	-20...+60 $^{\circ}$ C
Housing	50x35x25mm (LxWxH)
Response height	adjustable: 0/2mm - 5mm
Protection	IP67 (not suitable for continuous immersion)
Weight	approx. 210g including cable

CE Mark

The device fulfills the legal requirements of applicable EU-guidelines

INDICATION

Green LED	ON
Red LED	Alarm

ALARM

When an alarm is triggered, the red LED lights up and the integrated relay switches off (self-latching).

Water alarm:

Relay contact between yellow and green = open
Relay contact between yellow and grey = closed

Normal operation:

Relay contact between yellow and green = closed
Relay contact between yellow and grey = open

BAMO INTERNATIONAL

22, Rue de la Voie des Bans · Z.I. de la gare · 95100 ARGENTEUIL

Tel +33 (0)1 30 25 83 20 Web www.bamo.eu

Fax +33 (0)1 34 10 16 05 E-mail export@bamo.fr

Leakage monitor
WM25

LEV

544-07 /1

04-01-2018

M-544.07-EN-AD

RESET

After eliminating the cause of alarm, the device must be cleaned and dried.

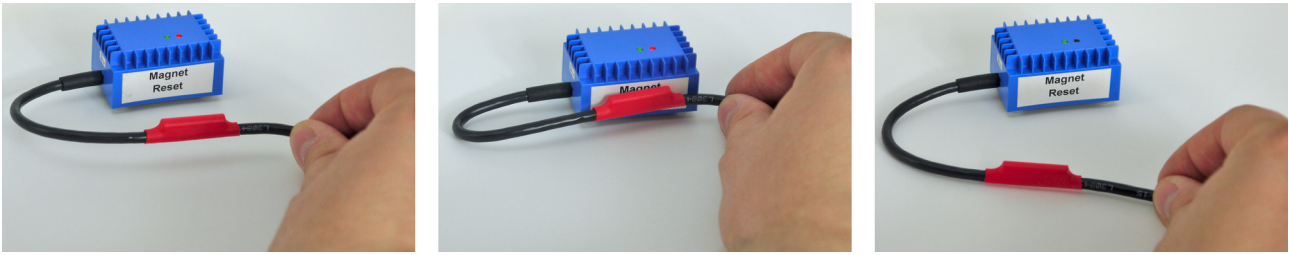

To perform the reset, lift the magnet, which is integrated in the cable and marked with a red shrink sleeving, onto the sticker with the inscription "MAGNET RESET".

When removing the magnet, the red LED must turn off again.

The alarm has now been reset and the WM25 is ready for use again.

ELECTRICAL CONNECTION

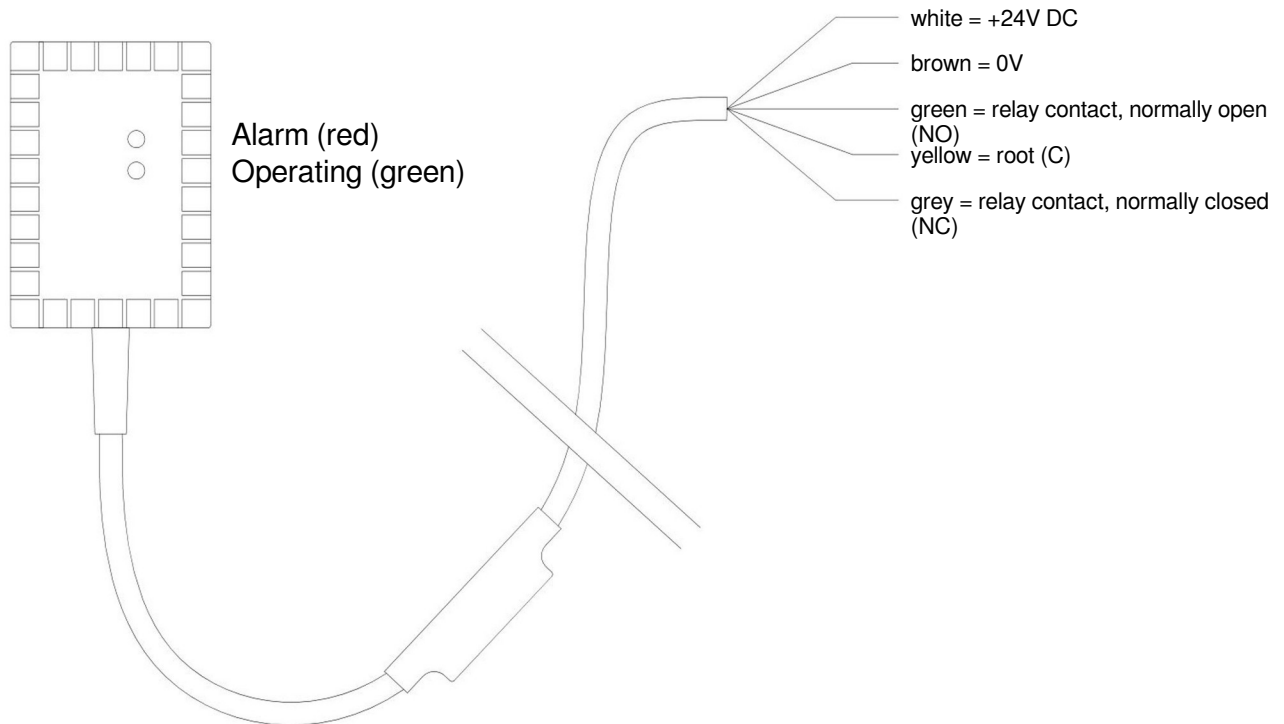

MAINTENANCE

The device is maintenance-free. It's advisable to clean and dry the sensor contacts after a water alarm.

BAMO INTERNATIONAL

22, Rue de la Voie des Bans · Z.I. de la gare · 95100 ARGENTEUIL

Tel +33 (0)1 30 25 83 20 Web www.bamo.eu

Fax +33 (0)1 34 10 16 05 E-mail export@bamo.fr

Leakage monitor
WM25

04-01-2018

M-544.07-EN-AD

LEV

544-07 /2