

# Pressure relief valves SDD 910



- All-plastic pressure relief valve
- Protection of pumps or systems
- Body in PPG or PVDF
- Union in PVC, PP or PVDF
- DN 10 and DN 15
- Adjustment range: 0.5...6 bar

## APPLICATIONS

- Protection of piping systems
- Maintaining upstream pressure
- Injection lances for dosing pumps

## DESCRIPTION

DD 910 pressure relief valves are designed to protect piping systems against overpressure and to maintain a constant upstream pressure, even in the event of pressure variations. Ideal for use with pumps, these versatile valves can be installed inline or in bypass, depending on requirements and in any position.

Manufactured with high-quality plastic materials for all wetted parts, SDD 910 valves feature diaphragms and seals available in EPDM or FPM to suit various applications. They are also effective as injection lances on dosing pumps, eliminating siphoning risks thanks to an adjustable and constant back pressure.

Equipped with an adjustment knob with automatic locking, SDD 910 valves simplify the adjustment process without requiring additional tools or wrenches.

## TECHNICAL FEATURES

Body	glass fiber reinforced PPH or PVDF
Diaphragm	EPDM or FPM
Union seal	EPDM or FPM
Bonnet	glass fiber reinforced PPH
Adjustment knob	glass fiber reinforced PPH
Fasteners	Stainless steel
Spring	Stainless steel
Insert	Brass
Sizes	DN 10 or DN 15
Hysteresis	approx. 0.3 bar
Adjustment range	0.5 ... 6 bar
Connection	union fitting for solvent welding (PVC), or socket fusion (PPH or PVDF)

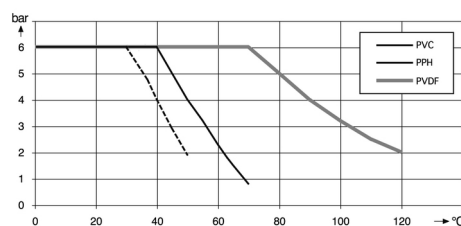

Pressure/Temperature curves depending on material

**BAMO** INTERNATIONAL

22, Rue de la Voie des Bans · Z.I. de la gare · 95100 ARGENTEUIL  
 Tel +33 (0)1 30 25 83 20 Web [www.bamo.eu](http://www.bamo.eu)  
 Fax +33 (0)1 34 10 16 05 E-mail [export@bamo.fr](mailto:export@bamo.fr)

Pressure relief valves  
**SDD 910**

10-04-2026

D-910.01-EN-AB

PLAS

910-01 /1

## FLOW CHARACTERISTICS

ND	Flow rate l/h*	Kv (l/h)**
10	900	1920
15	2000	2560

\* Maximum flow rates for a velocity of 3 m/s

\*\* Values given for water at 20 °C

This velocity is a maximum not to be exceeded in plastic materials. Beyond this, valves will deteriorate rapidly.

## CODE NUMBERS AND REFERENCES

Code	ND	Body / Unions	Seal & diaphragme	L	H	d	h	L1	Z
910 001	10	PPG / PVC	EPDM	124.5	89	16	18	91	97.5
910 002	15	PPG / PVC	EPDM	128	89	20	23	91	98
910 011	10	PPG / PVC	FPM	124.5	89	16	18	91	97.5
910 012	15	PPG / PVC	FPM	128	89	20	23	91	98
910 101	10	PPG / PP	EPDM	124.5	89	16	18	91	97.5
910 102	15	PPG / PP	EPDM	128	89	20	23	91	98
910 111	10	PPG / PP	FPM	124.5	89	16	18	91	97.5
910 112	15	PPG / PP	FPM	128	89	20	23	91	98
910 211	10	PVDF / PVDF	FPM	124.5	89	16	18	91	97.5
910 212	15	PVDF / PVDF	FPM	128	89	20	23	91	98

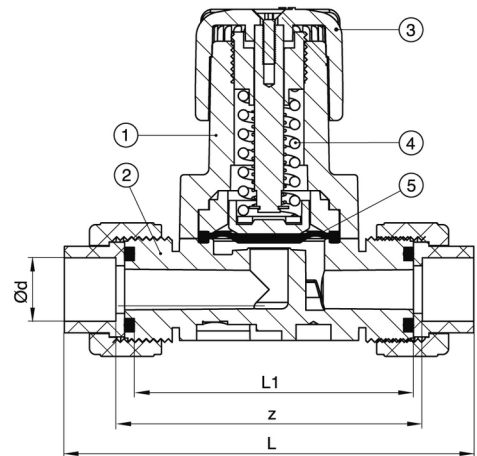
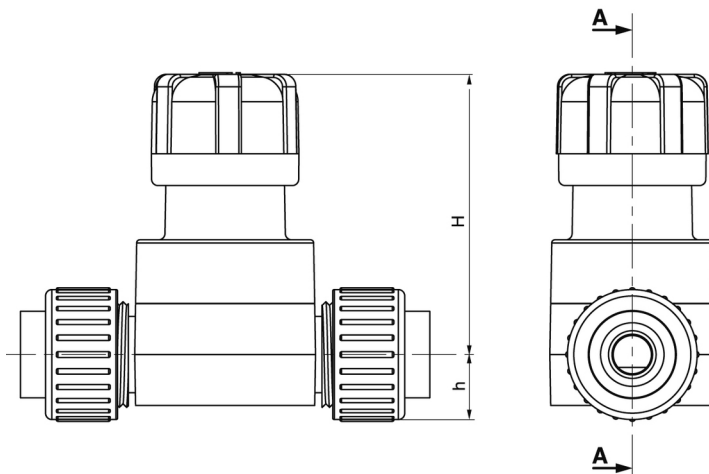
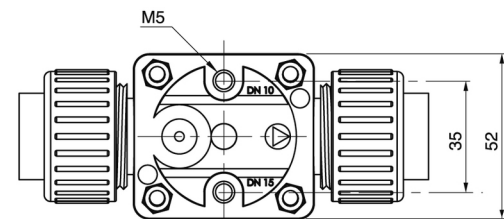

(1)	Bonnet in PPG (PP fiber-glass reinforced)
(2)	Body or in PPG or in PVDF
(3)	Adjustment knob in PPG
(4)	Spring in stainless steel
(5)	Diaphragm in EPDM or FPM

# BAMO INTERNATIONAL

22, Rue de la Voie des Bans · Z.I. de la gare · 95100 ARGENTEUIL

Tel +33 (0)1 30 25 83 20 Web [www.bamo.eu](http://www.bamo.eu)

Fax +33 (0)1 34 10 16 05 E-mail [export@bamo.fr](mailto:export@bamo.fr)

Pressure relief valves  
**SDD 910**

10-04-2026

D-910.01-EN-AB

**PLAS**

**910-01/2**