

# Manually operated 2-way ball valves, industrial series VM2V M1

- Secure and lockable handle
- In-line pattern
- 100% free way

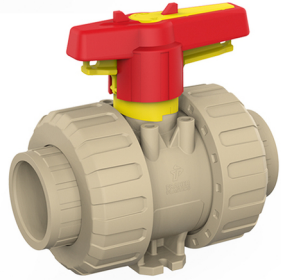

## DESCRIPTION

The material combinations available for the M1 series 2-way ball valves (or spherical plug valves) allow them to be used in industrial or chemical applications. The ball seat made of PTFE allows a long operating time. A secured and lockable handle prevents of any accidental operation. These modular valves, can receive limit switches, or even supporting adapters to mount electric or pneumatic actuator.

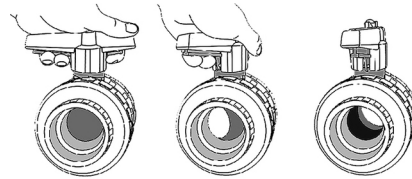

## TECHNICAL FEATURES

Body	PVC-U or PP-H or PVDF
Sealing	Seals in EPDM or FPM
Ball	Same material as the body
Ball seat	PTFE
Fittings	Unions (female) PVC, PPH or PVDF Other types or materials on request

### Accessories:

- Supporting adapters, 2 models:
- Adapter to mount an electric or pneumatic actuator.
- Adapter for limit switches

**EC Conformity:** The instrument meets the legal requirements of the current European Directives.

## CODE NUMBERS: referring to NB "nominal bore"

Body	PVC-U		PP-H		PVDF
	EPDM	FPM	EPDM	FPM	FPM
<b>NB 10</b>	AD128809	AD128819	BD124084	BD124140	CD124091
<b>NB 15</b>	AD128810	AD128820	BD124085	BD124141	CD124092
<b>NB 20</b>	AD128811	AD128821	BD124086	BD124142	CD124093
<b>NB 25</b>	AD128812	AD128822	BD124087	BD124143	CD124094
<b>NB 32</b>	AD128813	AD128823	BD124088	BD124144	CD124095
<b>NB 40</b>	AD128814	AD128824	BD124089	BD124145	CD124096
<b>NB 50</b>	AD128815	AD128825	BD124090	BD124146	CD124097
<b>NB 65</b>	AD124227	AD124230	BD124280	BD124283	CD124292
<b>NB 80</b>	AD124228	AD124231	BD124281	BD124284	CD124293
<b>NB 100</b>	AD124229	AD124232	BD124282	BD124285	CD124294

Pressure vs. Temperature

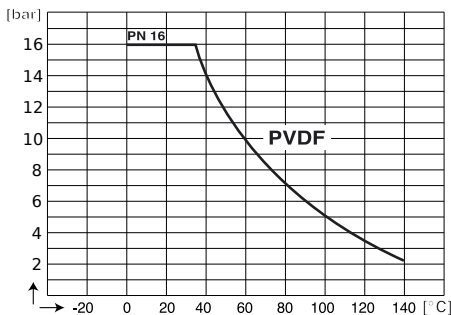
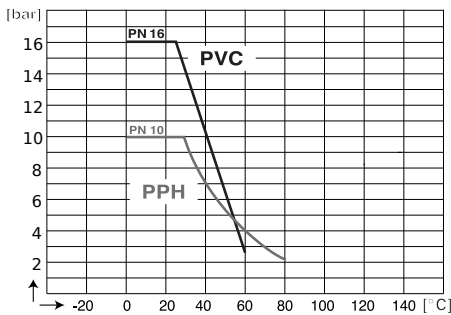

**BAMO** INTERNATIONAL

22, Rue de la Voie des Bans · Z.I. de la gare · 95100 ARGENTEUIL  
Tel +33 (0)1 30 25 83 20 Web [www.bamo.eu](http://www.bamo.eu)  
Fax +33 (0)1 34 10 16 05 E-mail [export@bamo.fr](mailto:export@bamo.fr)

Manually operated 2-way ball  
valves, industrial series  
**VM2V M1**

10-04-2026

D-934.04-EN-AE

PLAS

934-04/1

## DIMENSIONS [ mm ]

### Body in PVC-U – PN 16

	d	A	B	C	D	E	F	H	t	Z
NB 10	16	45	39.5	33	55.5	5.5	34	70.5	16	51
NB 15	20	45	39.5	33	55.5	5.5	34	70.5	16.55	50
NB 20	25	53.5	51	40	62	5.5	36	77	19.5	59.5
NB 25	32	54	51	43	70	6.5	38	79.5	23	60
NB 32	40	62	63.5	51	84	6.5	40	98	26.5	68.5
NB 40	50	78	72	56	101	6.5	45	105.5	31.5	86
NB 50	63	87	84	64	115	6.5	50	114	38.5	98
NB 65	75	111.5	110	85	149	8.3	65	142	44.5	122
NB 80	90	135.5	132	100	182	10.3	80	153	56.5	152.5
NB 100	110	135.5	132	100	182	10.3	80	153	61	162

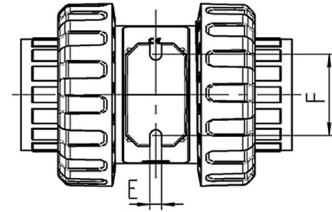

### Body in PP-H – PN 10

	d	A	B	C	D	E	F	H	t	Z
NB 10	16	61,5	40	33	58	5,4	34	74,5	14,5	69,5
NB 15	20	61,5	40	33	58	5,4	34	74,5	16	66,5
NB 20	25	69	51,5	40	68,5	5,4	36	83	17,5	78
NB 25	32	73	51,5	43,5	75,5	6,4	38	85,5	19,5	84
NB 32	40	83	64	51	92	6,4	40	104,5	22	97
NB 40	50	94	73	56,5	108	6,4	45	113	25,5	114
NB 50	63	109	85	64,5	127,5	6,4	50	121,5	29	136,5
NB 65	75	131,5	110	85	160	8,3	65	151,5	34,5	162
NB 80	90	156,5	132	100	196,5	10,3	80	167	38,5	206,5
NB 100	110	156,5	132	100	196,5	10,3	80	167	42	207,5

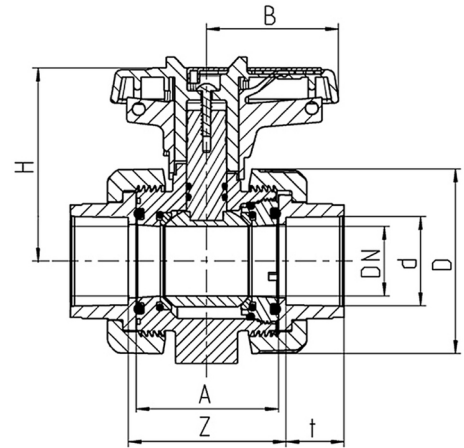

### Body in PVDF – PN 16

	d	A	B	C	D	E	F	H	t	Z
NB 10	16	61,5	40	33	56,5	5,4	34	74,5	14,5	69,5
NB 15	20	61,5	40	33	56,5	5,4	34	74,5	16	67
NB 20	25	69	51,5	40	67	5,4	36	83	17	78
NB 25	32	73	51,5	43,5	73,5	6,4	38	85,5	19,5	84
NB 32	40	83	64	51	90	6,4	40	104,5	22	97
NB 40	50	94	73	56,5	105,5	6,4	45	113	25	113
NB 50	63	108,5	85	64,5	124,5	6,4	50	121,5	29	136
NB 65	75	131,5	110	85	157,5	8,3	65	151,5	35	158,5
NB 80	90	156,5	132	100	192,5	10,3	80	167	38,5	205
NB 100	110	156,5	132	100	192,5	10,3	80	167	44	163

## Mass [ kg ]

	NB 10	NB 15	NB 20	NB 25	NB 32	NB 40	NB 50	NB 65	NB 80	NB 100
PVC-U	0.22	0.22	0.33	0.41	0.65	1.03	1.55	3.24	5.44	5.44
PP-H	0.22	0.22	0.33	0.41	0.65	1.03	1.55	3.24	5.44	5.44
PVDF	0.25	0.25	0.38	0.49	0.81	1.22	1.91	3.82	6.43	6.43

# BAMO

INTERNATIONAL  
 22, Rue de la Voie des Bans · Z.I. de la gare · 95100 ARGENTEUIL  
 Tel +33 (0)1 30 25 83 20 Web [www.bamo.eu](http://www.bamo.eu)  
 Fax +33 (0)1 34 10 16 05 E-mail [export@bamo.fr](mailto:export@bamo.fr)

**Manually operated 2-way ball  
 valves, industrial series  
 VM2V M1**

10-04-2026

D-934.04-EN-AE

**PLAS**

**934-04/2**

## PVC-U Valves, specificities

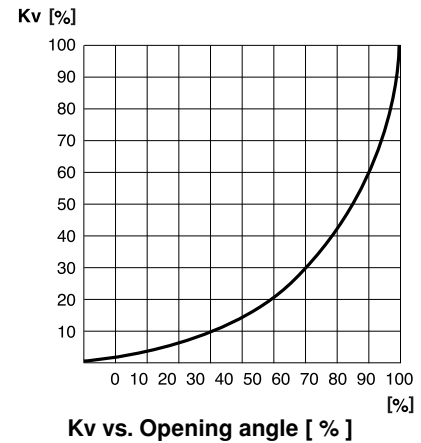
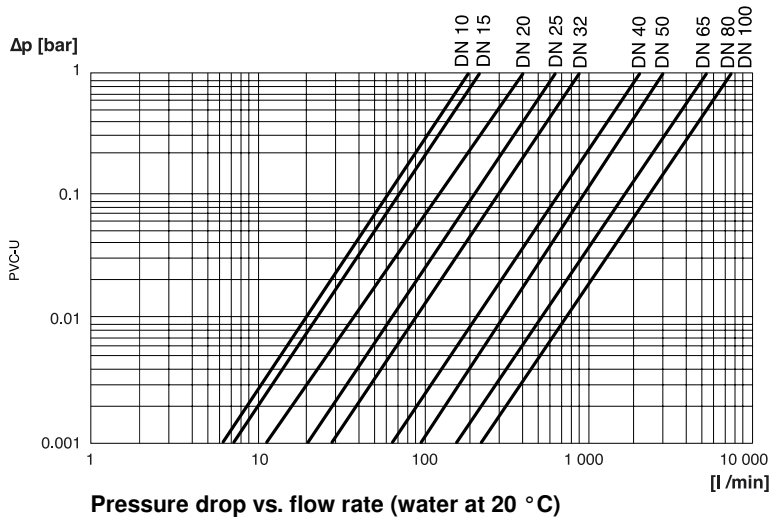

Kv values table (water at 20 °C):

NB	10	15	20	25	32	40	50	65	80	100
d	16	20	25	32	40	50	63	75	90	110
Kv [ l/min ] at pressure drop 1 bar	198	225	400	630	900	2120	3000	5150	7600	
Kv [ l/min ] at pressure drop 0.001 bar	6,2	7,1	12,6	19,9	28,4	67	94,8	162,8	240,3	

## PP-H and PVDF valves, specificities

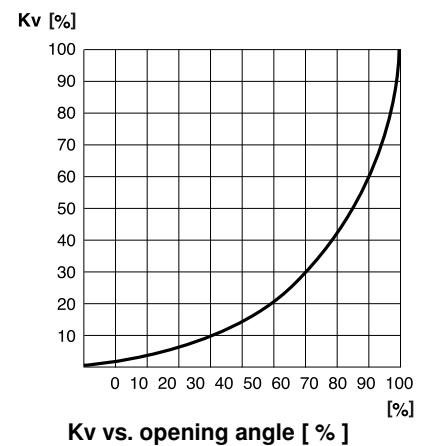
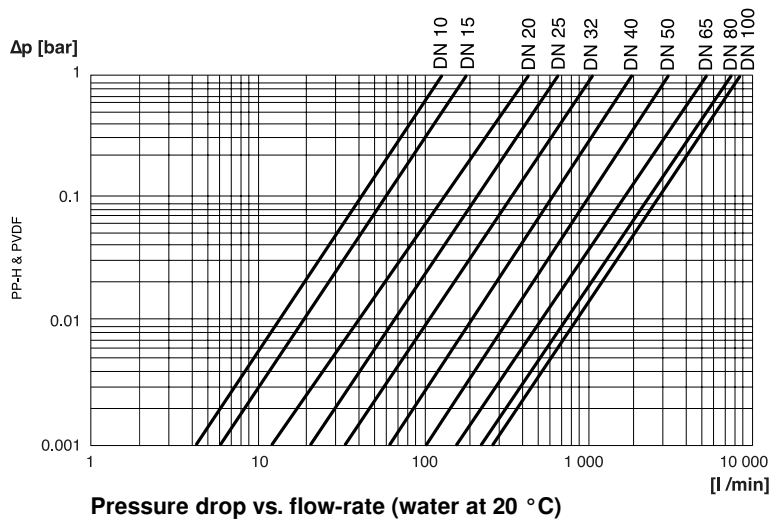

Kv values table (water at 20 °C):

ND	10	15	20	25	32	40	50	65	80	100
d	16	20	25	32	40	50	63	75	90	110
Kv [ l/min ] at pressure drop 1 bar	130	190	440	650	1080	1980	3240	5200	7500	8850
Kv [ l/min ] at pressure drop 0.001 bar	4,1	6,0	13,9	20,6	34,2	62,6	102,5	164,4	237,1	279,8

**BAMO** INTERNATIONAL

22, Rue de la Voie des Bans · Z.I. de la gare · 95100 ARGENTEUIL  
 Tel +33 (0)1 30 25 83 20 Web [www.bamo.eu](http://www.bamo.eu)  
 Fax +33 (0)1 34 10 16 05 E-mail [export@bamo.fr](mailto:export@bamo.fr)

Manually operated 2-way ball valves, industrial series  
**VM2V M1**

10-04-2026

D-934.04-EN-AE

**PLAS**

**934-04/3**

## ACCESSORIES

### Mounting support, double function, for valves M1 series

#### Description

- 1 accessory, 2 applications: As a blocking support or as a spacer
- Material: PA-G (black; fiber glass reinforced)
- For mounting on valves ND 10 up to ND 50

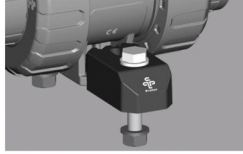

Function: As a Blocking support

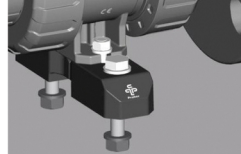

Function: As a spacer

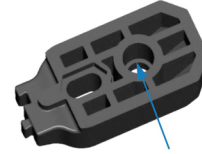

Bore for threaded bushing

<b>NB</b>	<b>10</b>	<b>15</b>	<b>20</b>	<b>25</b>	<b>32</b>	<b>40</b>	<b>50</b>
<b>d</b>	<b>16</b>	<b>20</b>	<b>25</b>	<b>32</b>	<b>40</b>	<b>50</b>	<b>63</b>
<b>T</b>		54				65	
<b>U</b>		25				32	
<b>V</b>		6.5				8.5	
<b>W</b>		16				22	
<b>X</b>	90		94	107	109	114	119
<b>X1</b>		70				85	
<b>Y</b>	49		56	65	73	78	86

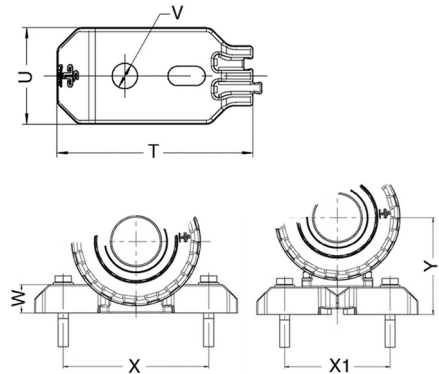

#### Code numbers

Code	Description
AD141776	Mounting support, double function for valves M1: NB 10, 15 and 20
AD141777	Mounting support, double function for valves M1: NB 25, 32, 40 and 50

### Mounting adapters for actuators on M1 series

#### Description:

- Material: PA-G (fiber glass reinforced)
- Stainless steel screws, included
- For mounting on valves NB 10 up to NB 80
- *More information: on request*

#### Code numbers:

Code	Description
AD129011	Adaptater for valves M1: NB 10 and 15
AD129012	Adaptater for valves M1: NB 20 and 25
AD129013	Adaptater for valves M1: NB 32
AD129014	Adaptater for valves M1: NB 40 and 50
AD210631	Adaptater for valves M1: NB 65
AD210632	Adaptater for valves M1: NB 80

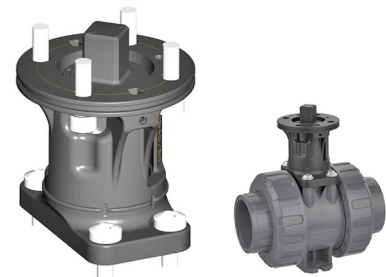

**BAMO** INTERNATIONAL

22, Rue de la Voie des Bans · Z.I. de la gare · 95100 ARGENTEUIL  
 Tel +33 (0)1 30 25 83 20 Web [www.bamo.eu](http://www.bamo.eu)  
 Fax +33 (0)1 34 10 16 05 E-mail [export@bamo.fr](mailto:export@bamo.fr)

Manually operated 2-way ball  
 valves, industrial series  
**VM2V M1**

10-04-2026

D-934.04-EN-AE

PLAS

934-04/4

## Limit switches kits for valves M1 series

### Description:

- For manually operated valves (1) or electric/ pneumatic actuators of our supply (2)
- Adjustable switches IP67; contact Ag-Ni: N.O. (NC\*), rated 15 ... 250 V AC (15...30 V DC); Limits 100 mA - 5A  
Contact Au\*: N.O.\* (N.C.\*), rated 5 ... 250 V AC (5 ... 30 V DC), Limits 1 mA - 3 A (\* : on request)
- Inductive contact IP 67, PNP\*/ NPN\*, rated 10 ... 30 V DC, Limits 0-100 mA or NAMUR\* 8 V DC (\* : on request)
- Operating temperature: -10 ... +50 °C
- Connector DIN IP 65
- Screws are not supplied

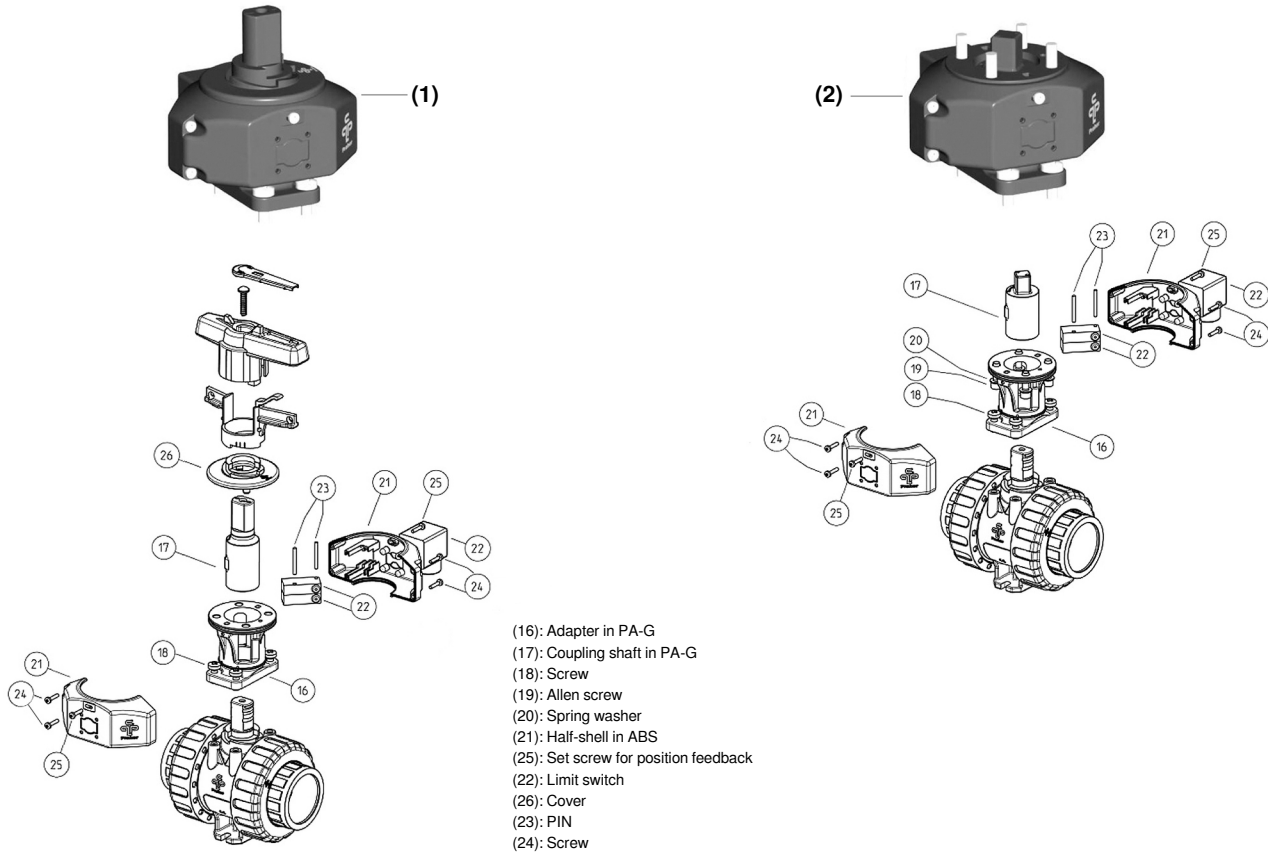

### Limit switches kit for manually operated valves M1 series:

Code	Description	Code	Description
AD129031	Kit, contacts N.O. (Ag-Ni), for NB 10 and 15	AD210635	Kit, inductive contacts PNP, for NB 10 and 15
AD129032	Kit, contacts N.O. (Ag-Ni), for NB 20 and 25	AD210636	Kit, inductive contacts PNP for NB 20 and 25
AD129033	Kit, contacts N.O. (Ag-Ni), for NB 32	AD210637	Kit, inductive contacts PNP for NB 32
AD129034	Kit, contacts N.O. (Ag-Ni), for NB 40 and 50	AD210638	Kit, inductive contacts PNP for NB 40 and 50
AD210633	Kit, contacts N.O. (Ag-Ni), for NB 65	AD210639	Kit, inductive contacts, PNP, 10 ... 30 V DC for NB 65
AD210634	Kit, contacts N.O. (Ag-Ni), for NB 80	AD210640	Kit, inductive contacts, PNP, 10 ... 30 V DC for NB 80

### Limit switches kit for actuated valves M1 series:

Code	Description	Code	Description
AD129159	Kit, contacts N.O. (Ag-Ni), for NB 10 and 15	AD210643	Kit, inductive contacts PNP, for NB 10 and 15
AD129160	Kit, contacts N.O. (Ag-Ni), for NB 20 and 25	AD210644	Kit, inductive contacts PNP, for NB 20 and 25
AD129161	Kit, contacts N.O. (Ag-Ni), for NB 32	AD210645	Kit, inductive contacts PNP, for NB 32
AD129162	Kit, contacts N.O. (Ag-Ni), for NB 40 and 50	AD210646	Kit, inductive contacts PNP, for NB 40 and 50
AD210641	Kit, contacts N.O. (Ag-Ni), for NB 65	AD210647	Kit, inductive contacts PNP, for NB 65
AD210642	Kit, contacts N.O. (Ag-Ni), for NB 80	AD210648	Kit, inductive contacts PNP, for NB 80

**BAMO INTERNATIONAL**

22, Rue de la Voie des Bans · Z.I. de la gare · 95100 ARGENTEUIL  
 Tel +33 (0)1 30 25 83 20 Web [www.bamo.eu](http://www.bamo.eu)  
 Fax +33 (0)1 34 10 16 05 E-mail [export@bamo.fr](mailto:export@bamo.fr)

**Manually operated 2-way ball  
valves, industrial series  
VM2V M1**

10-04-2026

D-934.04-EN-AE

**PLAS**

**934-04/5**