

# In-line measuring cell for 1 to 3 pH/ORP electrodes 9200

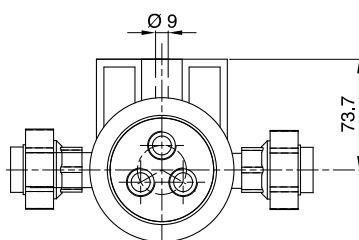
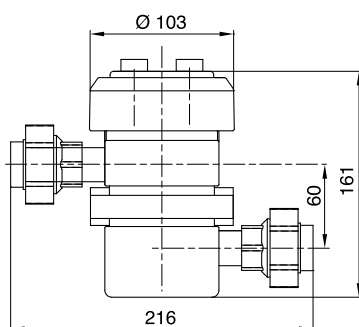

DIMENSIONS [ mm ]

## USER MANUAL

**BAMO** INTERNATIONAL

22, Rue de la Voie des Bans · Z.I. de la gare · 95100 ARGENTEUIL

Tel +33 (0)1 30 25 83 20 Web [www.bamo.eu](http://www.bamo.eu)

Fax +33 (0)1 34 10 16 05 E-mail [export@bamo.fr](mailto:export@bamo.fr)

In-line measuring cell for 1 to  
3 pH/ORP electrodes  
**9200**

24-07-2021

M-140.01-EN-AA

pH

140-01 /1

## PRECAUTIONS TO OBSERVE

- Assembly, commissioning and maintenance must be carried out by qualified technicians.
- Install the device, observing the limits specified in the technical specifications.
- Use adequate personal protections during disassembly or maintenance.
- This device only works under the conditions specified in this manual.

## DESCRIPTION

The cell holders 9200 series are used for pH / ORP measurements in-line, as well as for temperature measurement. They receive electrodes with Pg 13.5 fitting (data-sheet 150-01) and our temperature probes with PG 13.5 fitting (data-sheet 150-02) for temperature compensation. Materials are determined based on chemical compatibilities and operating conditions.

Mounting in piping: The inlet of liquid is lower than outlet in order to keep the electrode well immersed in the liquid.

For piping with diameter greater than 25 mm, mounting should be as a bypass and adding a pressure drop (restriction, elbow, valve etc.) in order to ensure correct circulation of the liquid. It is recommended to provide stop valves on the cell holder for all maintenance and calibration routines.

## TECHNICAL FEATURES

Temperature limits PVC: 0 ... 50 °C  
PPH: 0 ... 90 °C  
Max. pressure 6 bar  
Material PVC: Unions DN20, OD 25mm for solvent welding -- PPH: Unions DN20, OD 25 mm for fusion welding

**EC Conformity: The instrument meets the legal requirements of the current European Directives.**

## CODE NUMBERS AND REFERENCES

Standard versions: Supplied with 2 PG 13.5 plugs and 1 collar

Code	Reference	Description
140 301	9222	PVC in-line measuring cell for 1 to 3 electrodes
140 351	9223	PPH in-line measuring cell for 1 to 3 electrodes

## WARNING

Check that operating conditions are suitable for the in-line measuring cell and the electrodes, separately.

*Example: A pH electrode can be convenient for temperature up to 100 °C but the PVC cell must not exceed 50 °C.  
Therefore, for the whole system the temperature must not exceed 50 °C.*

## INSTALLATION

The 9200 type support is installed in-line or as a bypass.

**Caution: Respect the flow direction, the liquid must enter by the lower fitting of the cell.**

- Clean carefully the unions and piping with a cloth soaked in any stripper / degreaser liquid.
- Solvent welding or fusion welding: according to the materials.
- It is safer to drain the cell before disassembly; better to install stop valves upstream and downstream to facilitate maintenance works.

## MOUNTING THE ELECTRODE

The electrode is fragile, precaution must be taken to screw it on the holder by hand, not to strength it too much.

## MAINTENANCE

To avoid accumulation of deposits, it is recommended to check the inside of the cell (and the electrodes) at least once a month and to clean the system if necessary.

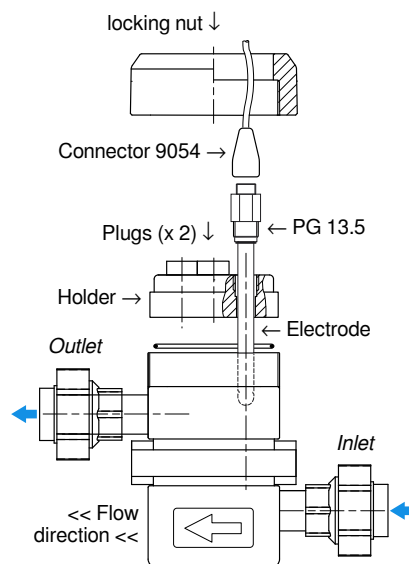

**BAMO** INTERNATIONAL

22, Rue de la Voie des Bans · Z.I. de la gare · 95100 ARGENTEUIL  
Tel +33 (0)1 30 25 83 20 Web www.bamo.eu  
Fax +33 (0)1 34 10 16 05 E-mail export@bamo.fr

In-line measuring cell for 1 to  
3 pH/ORP electrodes  
**9200**

24-07-2021

M-140.01-EN-AA

pH

140-01 /2