

Top mounted tank level indicator MAGTOP 400/410

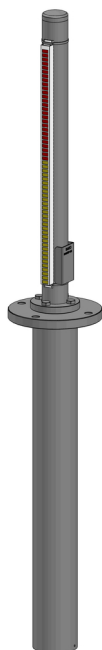

- Top mounting
- Magnetic bicolor flip-flag display
- Made in Stainless Steel AISI 316L
- Pressure resistant up to 16 bar
- Options: Magnetic level contacts, 4-20 mA analog output, Graduated ruler

APPLICATIONS

Level visualization and control in closed and/or buried metal tanks.

DESCRIPTION

The MAGTOP 400 and 410 are devices designed to indicate the liquid level in a tank in real time. A float, attached to a rod, causes a pointer to move up and down in a tube located above the tank, as the level rises or falls. Thanks to its two-color magnetic flaps that pivot as the pointer passes through the measuring column, it provides a clear and accurate visual reading. Its mechanical robustness allows it to be used with liquids such as hot water or oils subject to relatively high temperatures or pressures.

Operating conditions

This model is suitable for pressures up to 16 bar and maximum temperatures of 300 °C. For use beyond these limits, it is necessary to use the MAGTOP D model (see technical data sheet 560-03).

Assembly and modularity

The indicator is mounted on the tank using a flange connection. To simplify assembly or meet transport requirements, the MAGTOP 410 can be manufactured in two parts.

Manufacturing drawing

Each MAGTOP is manufactured according to a drawing that must be approved prior to production. For each MAGTOP, it is necessary to provide the operating conditions and connection specifications.

- Fluid nature
- Density (kg/m³)
- Pressure (bar)
- Temperature (°C)
- Connection size (Nominal Diameter)
- Immersion height (mm)
- Accessories (see below)

Options: Accessories

- Adjustable contacts on indicator tube (see data sheet 585-02)
- Continuous level transmission: Potentiometric or 4-20 mA analog signal for model supplied in one piece (see data sheet 586-01)
- Graduated scale in cm, %, or volume according to your specifications

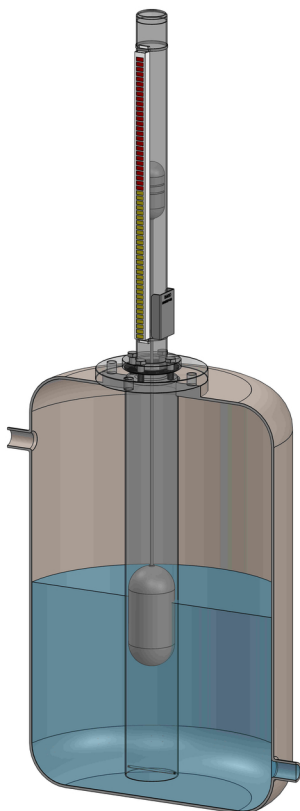

Installation principle

BAMO INTERNATIONAL

22, Rue de la Voie des Bans · Z.I. de la gare · 95100 ARGENTEUIL

Tel +33 (0)1 30 25 83 20 Web www.bamo.eu

Fax +33 (0)1 34 10 16 05 E-mail export@bamo.fr

Top mounted tank level
indicator

MAGTOP 400/410

23-07-2025

D-560.02-EN-AA

NIV

560-02 /1

DIMENSIONS

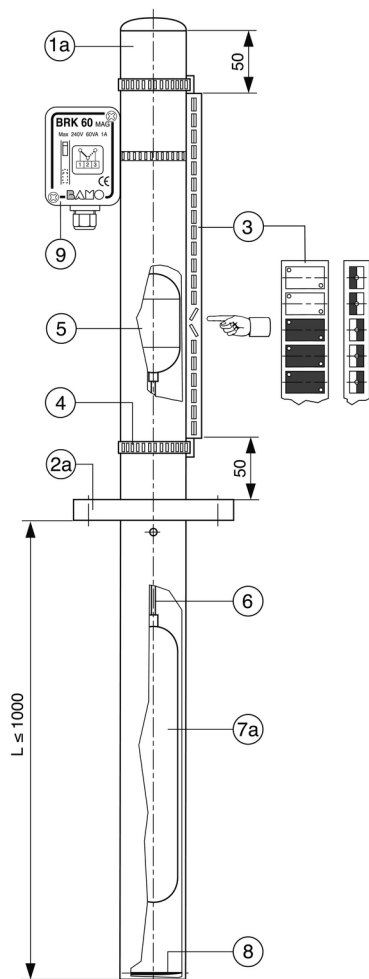

MAGTOP 400

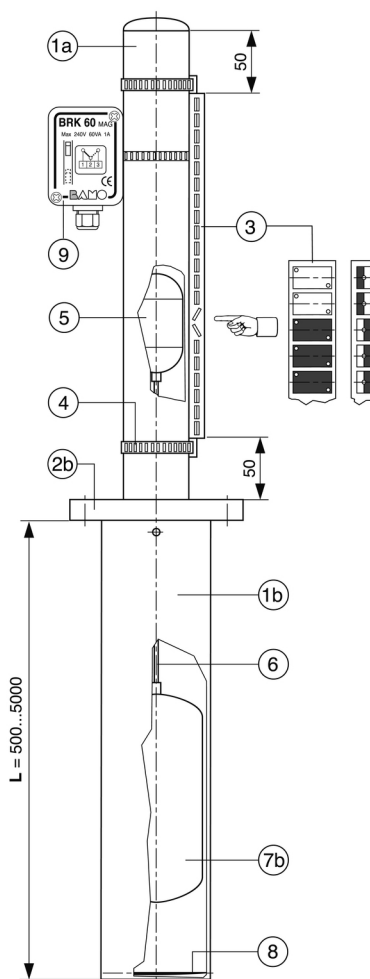

MAGTOP 410

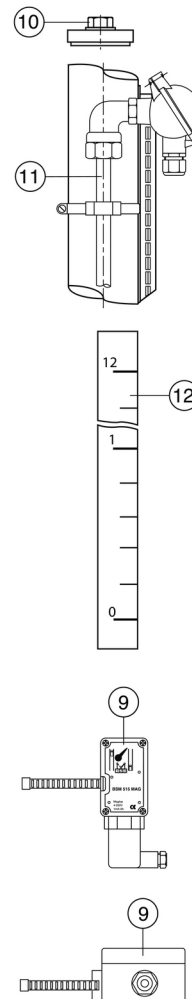

1a	316 L stainless steel indicator tube, Ø 60.3
1b	Stainless steel 316 L submerged tube, Ø 104, for float guidance
2a	Axial connection: Flange DN 80, DN 100, DN 125 / PN 16
2b	Axial connection: Flange DN 125 / PN 16
3	Makrolon viewing ruler with two-color magnetic flaps for level reading
4	Stainless steel 304 fixing collar
5	Magnetic index
6	Float/index connecting rod
7a	Float Ø 50, height 330
7b	Float Ø 90, height 195
8	Float stop
Options	
9	Magnetic level contacts BRK 60 or BSM 515 or BRT 60 ($T^{\circ} \leq 200^{\circ}C$)
10	1/2" BSP vent plug
11	Sensor stem with reed-chain for potentiometric or 4-20 mA continuous transmission (models in 1-part only)
12	Graduated ruler (volume, %, cm), in stainless steel

BAMO INTERNATIONAL

22, Rue de la Voie des Bans · Z.I. de la gare · 95100 ARGENTEUIL

Tel +33 (0)1 30 25 83 20 Web www.bamo.eu

Fax +33 (0)1 34 10 16 05 E-mail export@bamo.fr

**Top mounted tank level
indicator**

MAGTOP 400/410

23-07-2025

D-560.02-EN-AA

NIV

560-02/2